

Ordering Nieu fronts for BESTA cabinets is as easy as:

1 Determine
your door size,
style & finish

2 Enter
your details on
online order form

Include BESTA hinge
boring specifications

3 Order
and enjoy!



Select from:

- 20+ Door Styles
- 15 Colors
- DIY Options



These are recommended door sizes for BESTA frames. However, please **double check your measurements** and **confirm your product needs** prior to placing your order.

for BESTA
Drawer Front : 10"

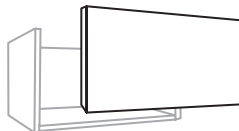

Customer must drill on site.

Order front size
23⁷/₁₆" x 10"

for BESTA
Drawer / Door Front : 15"

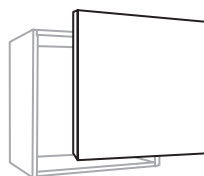

Order front size
23⁷/₁₆" x 15"

for BESTA
Door Front : 25"

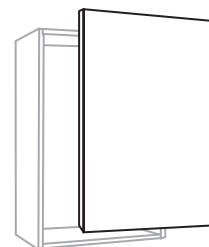

Order front size
23⁷/₁₆" x 25"

To price your BESTA fronts,
use our online order form!



To use BESTA
hinges

Write in 'Notes' Field for each front:
'Drill for BESTA hinges'.



Drawer Drilling

Customer is responsible to drill
BESTA drawer fronts on site.

For a Custom Look

Consider adding a panel to the top of your BESTA units!

To determine panel width, measure the total width of
BESTA units and order a panel to match.

For panel depth, we recommend 16³/₈"
Or order a custom sized panel

