

Ordering Nieu fronts for BESTA cabinets is as easy as:

**1** Determine  
your door size,  
style & finish

**2** Enter  
your details on  
online order form

Include BESTA hinge  
boring specifications

**3** Order  
and enjoy!



Select from:

- 20+ Door Styles
- 15 Colours
- DIY Options



These are recommended door sizes for BESTA frames. However, please **double check your measurements** and **confirm your product needs** prior to placing your order.

for BESTA  
Drawer Front : 10"

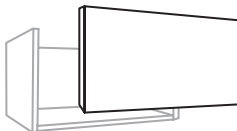

Customer must drill on site.

**Order front size**  
23<sup>7</sup>/<sub>16</sub>" x 10"

for BESTA  
Drawer / Door Front : 15"

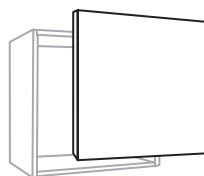

**Order front size**  
23<sup>7</sup>/<sub>16</sub>" x 15"

for BESTA  
Door Front : 25"

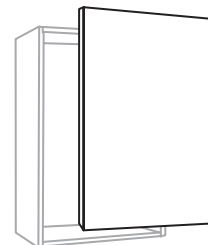

**Order front size**  
23<sup>7</sup>/<sub>16</sub>" x 25"

To price your BESTA fronts,  
use our online order form!



To use BESTA  
hinges

Write in 'Notes' Field for each front:  
'Drill for BESTA hinges'.



**Drawer Drilling**

Customer is responsible to drill  
BESTA drawer fronts on site.

**For a Custom Look**

**Consider adding a panel to the top of your BESTA units!**

To determine panel width, measure the total width of  
BESTA units and order a panel to match.

For panel depth, we recommend 16<sup>3</sup>/<sub>8</sub>"  
Or order a custom sized panel

