

nieu
cabinet doors



Nieu Door Guide

Useful information for your DIY cabinetry project

Framed vs Frameless Cabinets

Kitchen cabinets are typically constructed in one of two ways; either as a Framed or Frameless cabinet. Determining which style of cabinet you have in your kitchen is easy to do and is the first step in starting your DIY kitchen refacing project.

Framed Cabinets

More common in the US, these cabinets are easily identified by the frames that form the face of the cabinet. The frames are typically 1-1/2" wide and make for a more traditional looking kitchen while allowing for simple installation of doors. Framed kitchens typically have either Half or Full overlay doors which determine the amount of frame showing when the doors are closed.

Refacing Framed Cabinets:

When refacing a framed kitchen, the most common way to change the color of the exterior of the cabinet boxes and frames is to paint them with the matching paint color you've selected for your Nieu Cabinet Doors. Older framed kitchens will likely have exposed hinges but new soft close concealed hinges can be installed along with your Nieu Doors and drawer boxes. Trim pieces such as toe-kick, filler and panels can be ordered to clad large areas instead of painting such as the sides of an island, peninsula or cabinet.

Frameless (Euro Style)

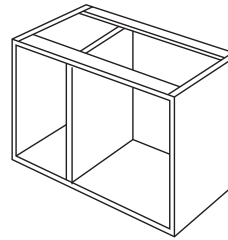

Face Frame Style

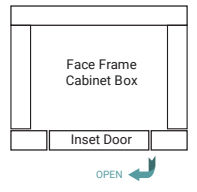
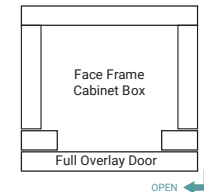
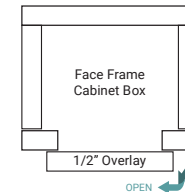
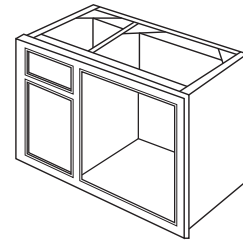

*Framed Cabinet Without Doors
1-1/2" Wide Frames Highlighted in Yellow.*

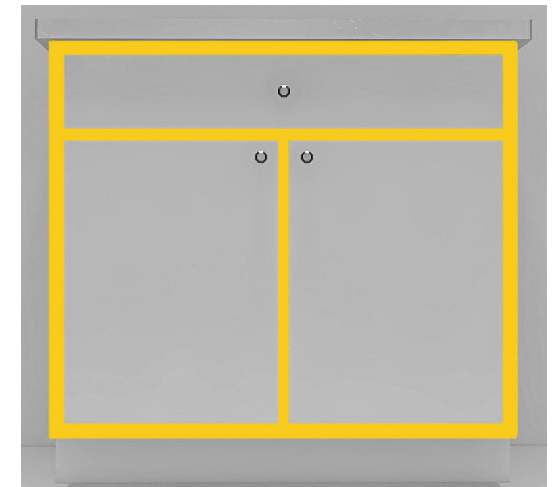

*Framed Cabinet with Half Overlay Doors
Exposed frames Highlighted in Yellow.*

Frameless Cabinets

Frameless cabinets are more popular in Europe and Canada and are often referred to as Euro-Style cabinets. IKEA has made them extremely popular with the DIY community as they are easy to assemble and install. Frameless cabinets do not have a face frame and utilize the sides of the cabinet for mounting hinges and drawer slides. One benefit of frameless cabinets is the full interior space is accessible.



Refacing Frameless Cabinets:

DIY refacing of frameless cabinets is a straightforward process of replacing side panels, toe-kick and doors with custom made to measure materials. Most frameless kitchens use panels screwed on to the sides of those cabinets with exposed sides. By ordering new panels you can simply unscrew the existing panel and replace it with a new one made to match the color of your Nieu Cabinet Doors. Toe-kicks and filler can be ordered to match your Nieu Doors and are easy to install. Hinges can be reused to save on cost, or new soft-close hinges can be ordered and installed on your Nieu Cabinet Doors.

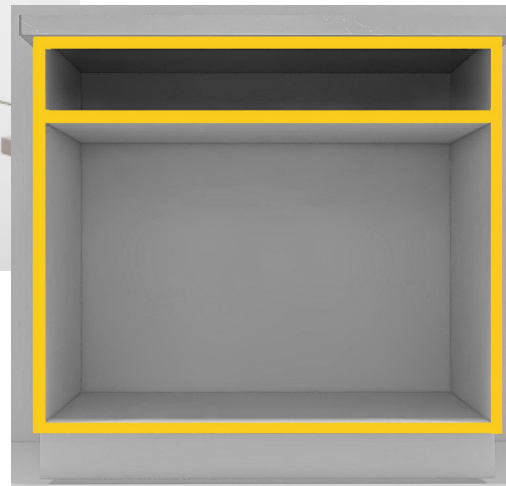

*Frameless Cabinet Without Doors
Made with 5/8" thick material.*



*Frameless Cabinet With Doors
No reveal, doors are flush with cabinet sides.*

Measuring Tips

Watch the **How To Measure videos** on the Nieu Website. Use the supplied graph paper to sketch the layout of your cabinets and be sure to have a measuring tape, pencil and painter's tape on hand.

Write down your measurements using Width x Height format.

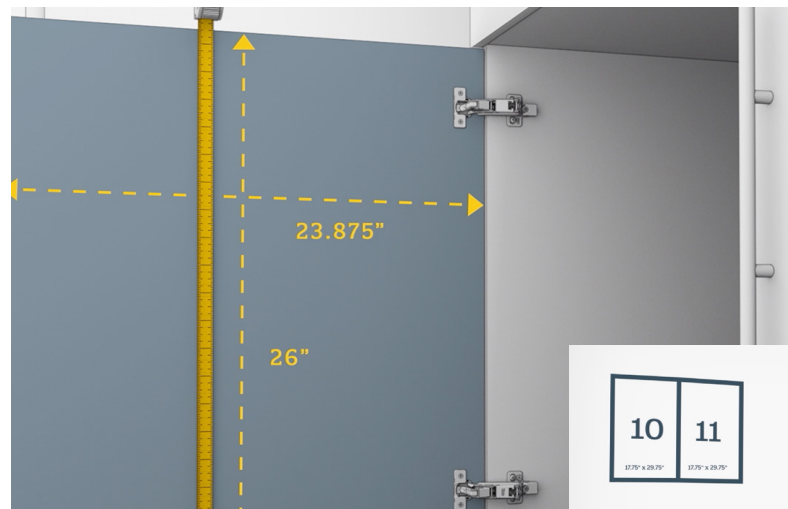

Use inches converted to decimals to capture your measurements.



Types of Corner Cabinets

Make note of the type of corner cabinet you have in your kitchen. Corners in kitchens typically have one of three styles of cabinets. You will need to know when it comes time to select the hinge type on the order form for the door(s) you have measured for your corner cabinet



Blind Corner

This type of corner cabinet requires long arms. Probably the least favorite of homeowners, these are often installed by builders as a cost saving measure.

Location: Blind Corner cabinets can be used for both Base cabinets and Upper Cabinets and depending on which corner they are in can have either left hand or right hand openings.

Hinge: Frameless cabinets require a pair of blind corner hinges. Be sure to select the **Blind Corner Hinge** on the order form. Framed cabinets don't require a special hinge for this type of cabinet.



45 Degree Angle Cabinet

This type of corner cabinet is a great spot for glass doors allowing you to show off fancy glassware. We can supply you with framed doors ready for glass. Glass inserts are best supplied and installed by your local glass shop.

Location: 45 Degree Corner cabinets are most often used for Upper Cabinets, however we do see them used for Base Cabinets too.

Hinge: Frameless cabinets require a pair of **45 Degree Hinges**. Be sure to select this hinge type on the order form. Framed cabinets don't require a special

Lazy Susan or Pie Corner Cabinet

We've never met a Susan who is lazy, but somehow Susan got a cabinet style named after her. These cabinets can be handy when equipped with a Lazy Susan circular shelf. Without it, you'd better have long arms.

Location: These cabinets can be installed as base or upper cabinets.

Hinges: This type of cabinet typically has two doors that are held together by an extra set of hinges. One pair of hinges attaches the first door to the cabinet. The second, or extra set of hinges holds the second door to the first door. When you select this hinge you will receive 2 x cabinet to door 170 degree hinges and 2 x door to door hinges. When ordering, select only one set of Lazy Susan hinges per Lazy Susan corner.



Drawer Boxes

Solid birch dovetailed drawer boxes offer the perfect balance of beauty and utility. Replace old, broken, or worn out drawers with custom sized, full extension, soft close drawer boxes paired with your Nieu doors.

Replace old drawer boxes, or convert a cabinet with doors to a pot and pan drawer stack to improve the functionality of your space.

Available in custom widths and several height and depth combinations to fit all cabinet types. Sold with optional undermount, full extension, soft-close slides.



- 5/8" thick solid birch construction
- Dovetail joinery built for a lifetime of durability
- Low VOC, clear UV finish for extra water resistance
- 3/8" matched melamine bottom for added capacity
- Shipped assembled for easy installation
- Soft-close glides available to purchase

Depth						
Inches (")	11.8	13.77	15.75	17.7	19.69	21.65
Millimetres (mm)	300	350	400	450	500	550

Height							
Inches (")	2.25	3.75	4.125	5.5	6.875	9.0625	10.25
Millimetres (mm)	57	95	105	140	175	230	261



Drawer Faces

When ordering drawer faces, choose from routed or slab options to achieve your desired look. Routed will have the same profile detail as your door style, while slab is a simple flat front.

For shaker style fronts, any drawer that is shorter than 5 1/2" in height will be too small for a routed detail, and must be ordered as a slab.

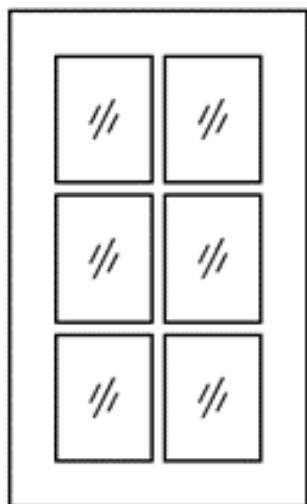
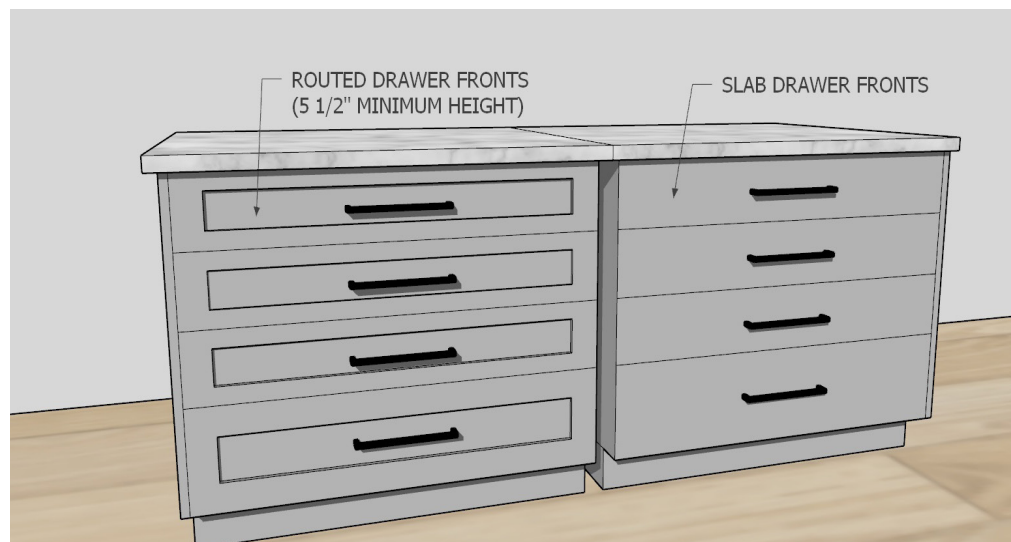

Mullion

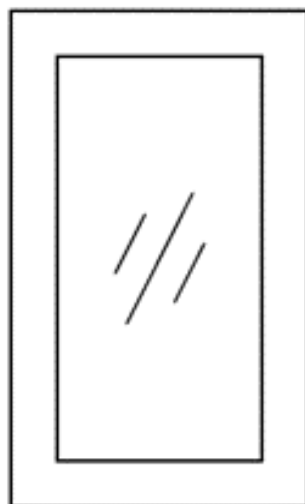

Frame Only

Glass-Ready Doors

When ordering cabinet doors from Nieu, you have the option to select glass-ready doors.

Glass cabinet doors can break up a wall of solid cabinetry and add a spot for decorative items to show off!

We will make your doors ready for glass templating and insertion at a local glass shop, but we don't ship the glass itself.

Floating Shelves

Eliminate upper cabinets or add decorative storage with custom sized floating shelves.



Depths: 8, 10, 12 inches

Widths: 12 - 72 inches (available in 1" increments)

Thickness: 1.5"



Triade Maxi mounting bracket included.
[Click here to watch how to install.](#)

Available Primed or Painted in our standard colors



Recommended Tools

Drill with Assorted Drill Bits

Assorted Screw Drivers

7" Rafter or Quick Square

24" I Beam Level

Mitre Saw (for panels and trim)

Table Saw (for panels and trim)

Painter's Tape

Drop Cloths

Knob and Pull Drilling Template

Eye & Respiratory Protection

Tips and Best Practices

Cover all surfaces with drop cloths especially counter-tops.

Empty cabinet contents (good time to throw away those 10 year old cans of soup).

Clear kitchen work area of furniture.

Start with panels and trim. Install doors last.

If painting the exterior of the cabinets make sure paint is dry before hanging doors.

Use a pencil to mark all holes for drilling.

Use painter's tape when drilling holes to limit chipping.

Drill handle or knob holes from the front of the door to the back.

Leave Nieu stickers on the back of the doors until the job is complete. If you need to reorder a door send us the information on the sticker.

Always wear eye and respiratory protection.

If you are installing new countertops, have them installed before replacing your doors.

Measure twice, cut or drill once. If unsure, measure again.

When the job is complete, be sure to Brag. You made your kitchen look so darn good!

Conversion Table

Fraction	Decimal
1/16	0.0625
1/8	0.125
3/16	0.1875
1/4	0.25
5/16	0.3125
3/8	0.375
7/16	0.4375
1/2	0.5
9/16	.5625
5/8	0.625
11/16	0.6875
3/4	0.75
13/16	0.8125
7/8	0.875
15/16	0.9375

We're Here to Help

If you have any questions or require assistance with measuring your kitchen please contact us at:

contact@nieucabinetdoors.com



Paint Colors

1. [Click here](#) to order a Nieu sample kit.

Each of our colors has been selected to be on-trend, decor friendly, and stylish for your kitchen.

2. Get swatches at your local Sherwin Williams.

By using Sherwin Williams paint on all our doors, we've partnered with a well-known, global brand with years of experience manufacturing quality products.

	Nieu Color: Winter White
	Sherwin Williams: Extra White
	Sherwin Williams: SW7006

	Nieu Color: Whimsical White
	Sherwin Williams: Snowbound
	Sherwin Williams: SW7004

	Nieu Color: Warm White
	Sherwin Williams: Alabaster
	Sherwin Williams: SW7008

	Nieu Color: Brightly Beige
	Sherwin Williams: Repose Gray
	Sherwin Williams: SW7015

	Nieu Color: Totally Taupe
	Sherwin Williams: Requisite Gray
	Sherwin Williams: SW7023

	Nieu Color: Trendy Teal
	Sherwin Williams: Interesting Aqua
	Sherwin Williams: SW6220

	Nieu Color: Sweetly Sage
	Sherwin Williams: Riverway
	Sherwin Williams: SW6222

	Nieu Color: Only Olive
	Sherwin Williams: Sage Green Light
	Sherwin Williams: SW2851

	Nieu Color: Dream Dusk
	Sherwin Williams: Rock Bottom
	Sherwin Williams: SW7062

	Nieu Color: Bonny Black
	Sherwin Williams: Black Magic
	Sherwin Williams: SW6991



0'

1'

2'

3'

4'

5'

6'

7'

8'

9'

10'

11'

12'

13'

14'

15'

16'

17'

0'

1'

2'

3'

4'

5'

6'

7'

8'

9'

10'

11'

12'

13'

Door Color:

Door Style:



NieuCabinetDoors.com



Buy Now, Pay Later

No interest. No Fees. Break your purchase into four (4) equal payments using your existing credit card.

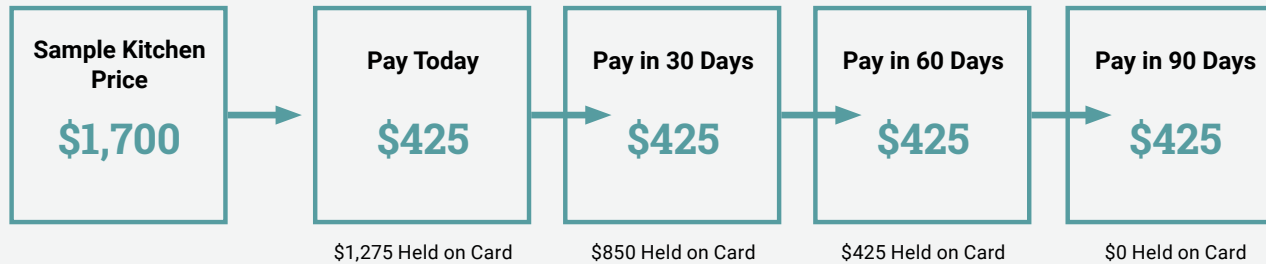

[LEARN MORE](#)



The Angela Rose Home Collection

Introducing our signature collection of cabinet doors with Angela Rose Home. A modern take on the classic shaker door – by top DIY and Design influencer. @angelarosehome

[LEARN MORE](#)